

For Low Pressure (Air)

LINE CUPLA

200T Type, 200L Type, 200S Type

Simple design air line coupling on manifold

Working pressure

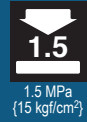

Valve structure



Applicable fluid



Enables several air lines to be taken simultaneously from one supply line!

- Just push in the plug into socket for simple and secure connection.
- Multiple outlets are available from single air supply source.
- Choose from the 2-outlet type (Model 200T), the 5-outlet straight type (Model 200L) and the 5-outlet star type (Model 200S) to suit your application.



200T type
(comes with dust caps)

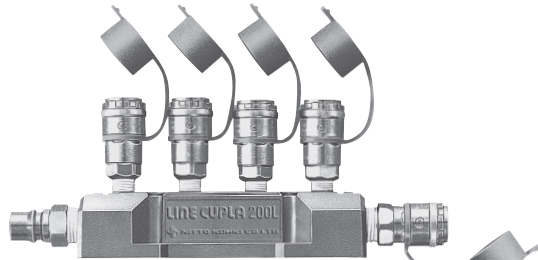

200L type
(comes with an accessory 400SH and dust caps)

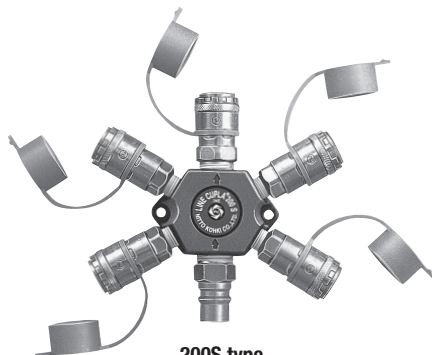

200S type
(comes with an accessory 400SH and dust caps)

Specifications

Body material	Body : Aluminum alloy, CUPLA : Steel (Chrome plated)			
Size	Inlet	200T Type : 20PM 200L Type / 200S Type : 400PM		
	Outlet	200T Type : 200-20SM 200L Type / 200S Type : 200-20SM, 40SM		
Pressure unit	MPa	kgf/cm ²	bar	PSI
Working pressure	1.5	15	15	218
Seal material	Seal material	Mark	Working temperature range	Remarks
Working temperature range	Nitrile rubber	NBR (SG)	-20°C to +60°C	Standard material

• The products come with dustproof caps.

Flow Direction

Fluid must run from the inlet port to the outlet ports.

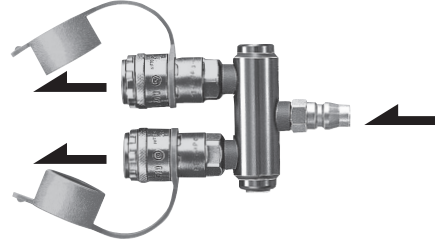

Interchangeability

Interchangeable with plugs of HI CUPLA models 10, 17, 20, 30 and 40.
Interchangeable with each models of NUT CUPLA series and HI CUPLA series.
Please see [page 19](#) for "HI CUPLA Series Interchangeability".

Minimum Cross-Sectional Area

(mm²)

Model	200T type, 200L type, 200S type
Minimum cross-sectional area	19

Suitability for Vacuum

Not suitable for vacuum application in either connected or disconnected condition.

Pressure - Flow Characteristics

[Test conditions] • Fluid : Air • Temperature : Room temperature

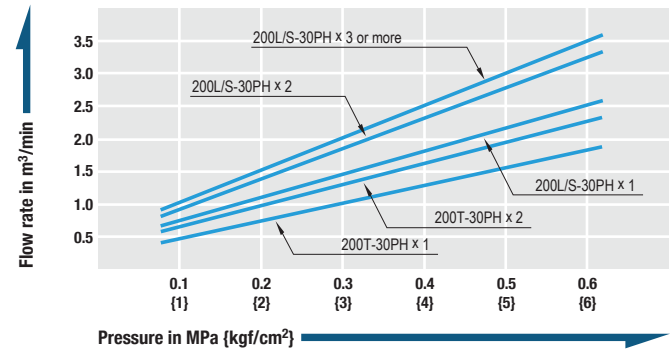

Socket 200T type (For two outlets)

Mass : 272 g

- Fluid must run in the direction of the arrow.
- The product comes with dust caps.

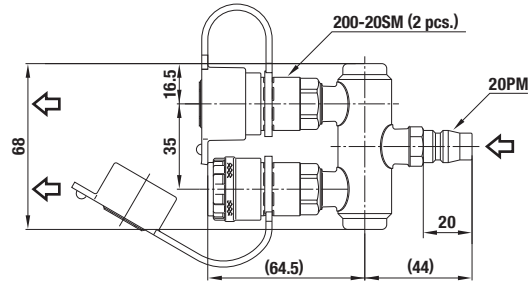

Dimensions (mm)

Socket 200L type (For five outlets, in-line type)

Mass : 890 g

- Fluid must run in the direction of the arrow.
- The product comes with dust caps.
- Accessory : 400SH

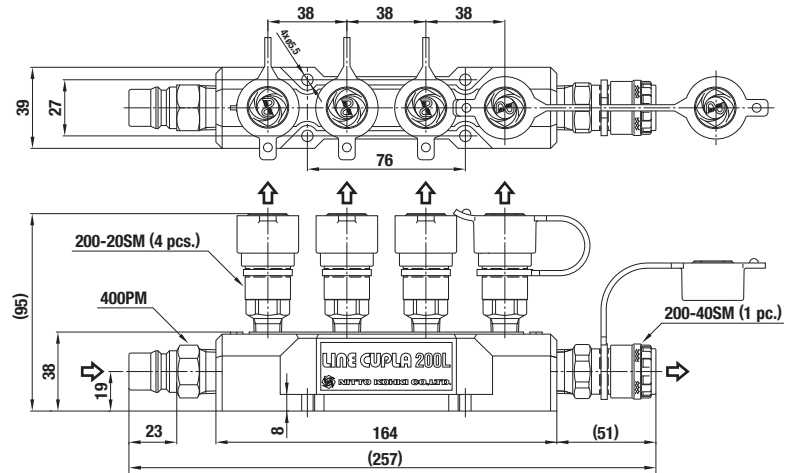

Dimensions (mm)

Socket 200S type (For five outlets, star type)

Mass : 769 g

- Fluid must run in the direction of the arrow.
- The product comes with dust caps.
- Accessory : 400SH

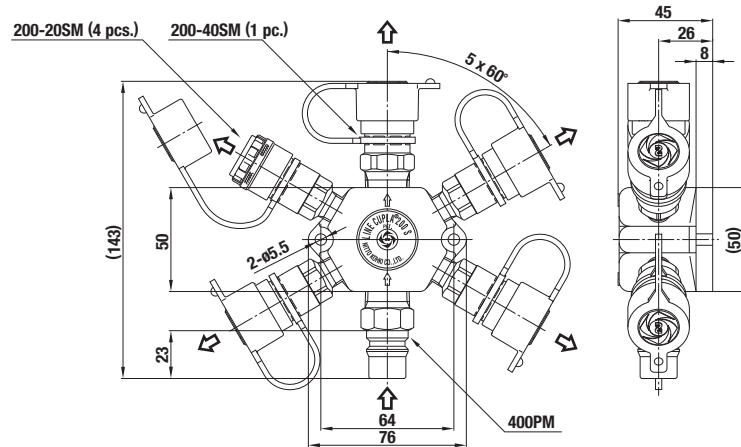

Dimensions (mm)

Application Example

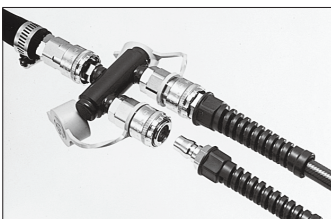

Optional Items : PRESSURE GAUGE and DRAIN COCK

"PRESSURE GAUGE" and "DRAIN COCK" are available as optional items to be mounted on LINE CUPLA 200. (See [page 151](#))

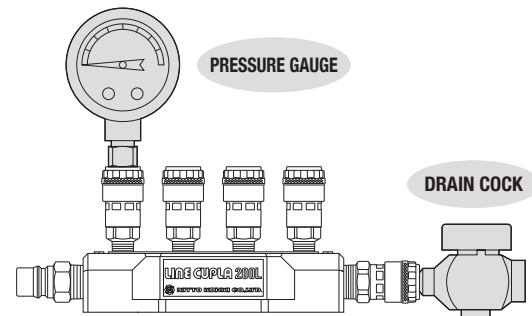

Appearance subject to change for improvement without notice.